

MD-2105 Wired Smoke Detector User Manual

1. Product structure

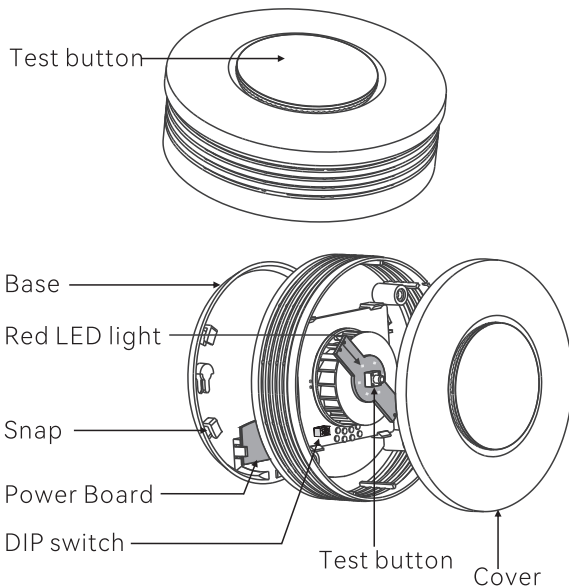

2. Function Introduction

This smoke detector is with test button, can accurately detect smoke. when the smoke concentration exceeds the limit level, the red led will light on for 10 secs and send alarm signal to alarm panel.

3. Technical indicators

Model: MD-2105

Working voltage: 12V non-polar power supply

Working environment: temperature $-10^{\circ}\text{C} \sim 55^{\circ}\text{C}$;
humidity 10% ~90%

Alarm output indication: The red LED is always on

NO output mode: monitor current $<2\text{mA}$,
alarm current $<30\text{mA}$

NC output mode: monitor current $<30\text{mA}$,
alarm current $<10\text{mA}$

Size: $\phi 108 * H40\text{mm}$

4. Disassembly method and installation

① Disassembly:

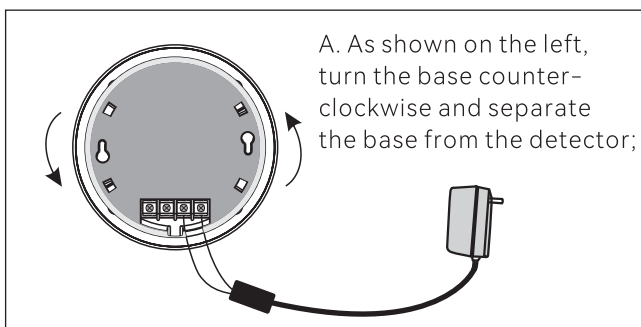

B. Use a screwdriver to remove the four screws on the right and separate the cover.

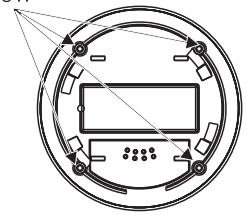

② Installation:

A. Screw into the wall according to the hole on the base;

B. Hang the base and push it down until it snaps into place;

C. Align the buckle to access the detector and turn clockwise to fix.

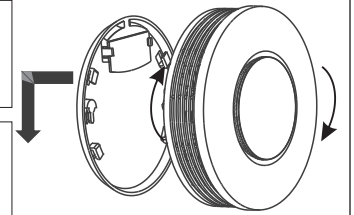

5. Functional Description

① Test:

Press the test button to release the relay output NC/NO signal, the red LED lights on 10 seconds. You can also choose the method of release smoke into the detector to trigger the detector, when the concentration of smoke reaches a certain extent, the red LED lights on constantly means detector is working.

② DIP switch:

NO.	ON	OFF
1	Alarm lock	Automatic reset (default)
2	Normally closed output	Normally open output (default)

Note: After changing the settings, you need to power off the detector after 15 seconds and re-power.

6. Precautions

① Do not install near the door, windows, fans, etc., as the air in these areas will circulate quickly, which will reduce the sensitivity of the detector.

② Can not be installed in high humidity or high temperature locations, such as bathrooms, attic.

7. Easy maintenance

Please clean the detector every 3 months to maintain the stability of the detector.